

iThermometer

Wearable Thermometer with Continuous Monitoring

USER MANUAL

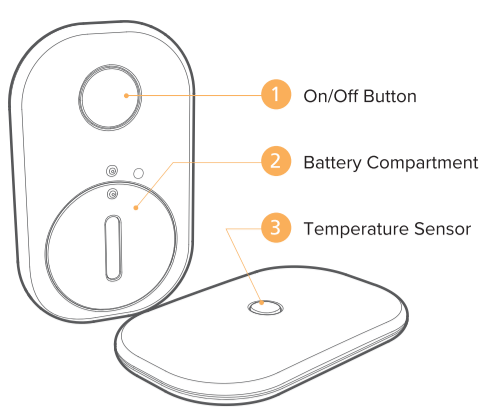

CONTENTS

| | | |
|-----------------------------------|-------------------------------|--|
| 1. Accessories | 8. Maintenance & Preservation | 15. Caution |
| 2. Intended Use | 9. Cleaning & Disinfection | 16. Declaration |
| 3. Application | 10. Important Precautions | 17. Copyright Statement |
| 4. Getting Started | 11. Technical Specifications | 18. Standard Warranty Information |
| 5. Additional Details for Wearing | 12. Functional Description | 19. Appendix |
| 6. Operating Instructions | 13. Definitions of Symbols | 20. Purchasing Record for iThermometer |
| 7. Troubleshooting | 14. Disclaimer | |

| | |
|--------------------|--|
| Definitions | Device/Thermometer: iThermometer wearable thermometer Receiver: Smart mobile device that runs the iThermometer App and receives a Bluetooth signal from the thermometer |
|--------------------|--|

1. ACCESSORIES

1. One CR2025 battery
2. One battery tool
3. Medical patches (1 box)
4. User manual

2. INTENDED USE

The Wireless Thermometer is a battery-operated electronic device with the intended use of measuring and monitoring human axillary temperature continuously and transmitting the results via wireless signal.

3. APPLICATION

The device is reusable and intended for temperature measurement of adult and pediatric (ages two years and over). It can be used in hospital and at home.

Not suitable for ICU or other emergency situations.

4. GETTING STARTED

1 Insert battery

Change battery: use the battery tool and rotate clockwise to open.

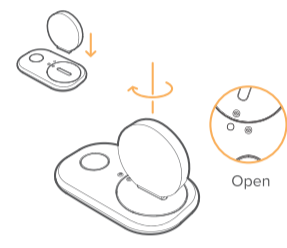

Insert battery.



Note: Make sure that the battery is in good contact with the cathode and the anode while inserting, also do not bend the anode inside the battery compartment.

Rotate counterclockwise to close.

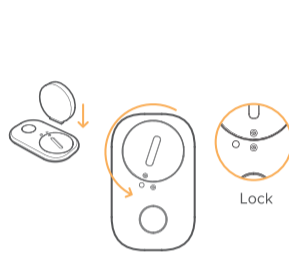

2 Download app

1. Go to App Store or Google Play and search "iThermometer".
2. Download iThermometer app.



3 Setting up connection

1. Turn on the receiver and its Bluetooth, making sure the receiver is connected to the Internet.
2. Switch on the device (Press the button for more than 2 seconds. A single LED blink indicates power is on.)
3. Open the iThermometer app on the receiver and sign in.
4. Follow the instruction "Tap to connect device."
5. Choose the device on the list. (Serial number should appear)
6. Wait for synchronization.
7. The temperature should appear on the app.



4 Wearing preparation

Step 1
Remove the cover of the patch.



Step 2
Face the temperature sensor up and stick the other side (with button) to the patch. Make sure the device is in the center of the patch.



For the most accurate results, make sure the device has been at room temperature for at least 5 minutes before using it.

5 Wearing

Step 1. Lift the arm naturally.



Step 2. Apply the device just below the armpit.

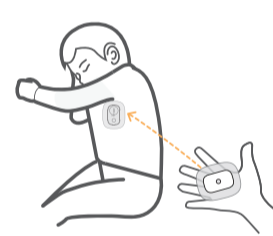

Note: An adult should help children wear and operate the device, to ensure the area of skin that contacts with the device stays flat and smooth.

Step 3. Hold arm tight against side for at least 8 minutes.

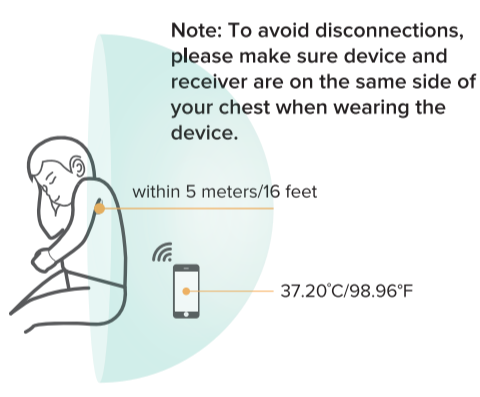

6 Remote Monitoring (Optional)

1. Prepare two receivers (A & B) connected to the Internet.
2. Run iThermometer app on receiver A and set up the Bluetooth connection between receiver A and the device.
3. Wear the device.
4. Run iThermometer app on receiver B and sign in with the same account as receiver A.
5. In iThermometer app on receiver B, select the family member being monitored by receiver A.

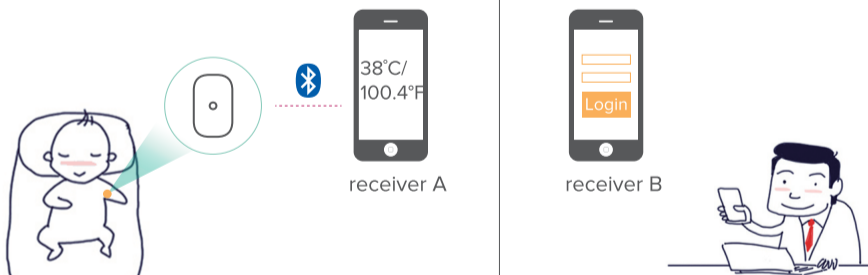

5. ADDITIONAL DETAILS FOR WEARING

- We recommend that users use the patches we provide from the original manufacturer. Wear the device in a cool, neutral thermal environment for a better wearing experience. DO NOT wear the iThermometer in the same place for more than 24 consecutive hours. If you feel unwell (uncomfortable or allergic) when using the patch, replace it with another type of patch based on your doctor's advice. A fully-covered patch (no smaller than 76mm × 62mm) should be used.
- Do not reuse patches. If a patch is already folded over, a new patch is required.
- Shave armpits in advance. Make sure

- the area of skin in contact with the patch is flat and smooth.
- Clean the surface of the device with 75% concentrated medicinal alcohol before and after using it. The material that contacts skin is non-toxic, non-irritating, and will not cause allergies or any other side effects.
- To avoid disruption due to an incoming call or text message during the measurement, we recommend switching your receiver to flight mode and turning on Bluetooth and Wi-Fi.
- **For the most accurate results, make sure the device has been at room temperature for at least 5 minutes before using it.**

6. OPERATING INSTRUCTIONS

1. Button functions

- Long press (more than 2 seconds): Switches device on. A single LED blink indicates power is on.
- Short press (less than 2 seconds): Checks status. A single LED blink indicates that device is connected to a receiver. A double blink indicates that device is not connected to a receiver. No LED blink indicates that device is off.
- Double click and hold the button for 2 seconds: Switches device off. LED lights up for 2 seconds to indicate power is off.

6. OPERATING INSTRUCTIONS

2. Frequent operation patterns:

- 2.1 Connecting to receiver for the first time:
- a) Turn on the receiver and turn on Bluetooth, making sure the receiver is connected to the internet.
 - b) Long press button to turn on the device.
 - c) Run iThermometer app on the receiver and sign in.
 - d) Connect the device with the receiver. If the device is not connected with the receiver within 60 minutes after turning on, the device will turn itself off automatically.
 - e) Wear the device.

- 2.2 Connecting to previously connected receiver:
- a) Turn on the receiver and turn on Bluetooth.
 - b) Long press button to turn on the device.
 - c) Run iThermometer app on the receiver to monitor body temperature. Connection will be established automatically. (If you manually disconnected the device from the receiver the previous time you used it, you will need to manually connect this time.)
 - d) Wear the device.

3. Measurement and storage:

The device will continue to measure and store body temperature independently even if the Bluetooth connection fails during monitoring. The device will sync with the receiver automatically as soon as the connection is restored. The device can store a maximum of 10 days of data. If you turn on the device without wearing it, the device will turn itself off automatically after 60 minutes.

7. TROUBLESHOOTING

| Symptom | Possible Reasons | Solutions |
|---|---|--|
| Temperature data not displayed properly | 1. Low battery | 1. Restart the device 2. Replace the battery |
| Device is not switched on | 1. Low or no battery power 2. The device might be damaged | 1. Replace the battery 2. Contact customer service |
| Unusual temperature data | 1. The device might not be worn correctly 2. The device might be damaged 3. Arm was not held tight against side for first 8 mins 4. Device has not been at room temperature for at least 5 minutes before using 5. The device was placed in a problematic place, or there are other body conditions causing interference. | 1. Check wearing position of device 2. Contact customer service 3. Hold arm tight against side for 8 mins again 4. Keep the device at room temperature (without touching or heating it) for at least 5 minutes 5. Ask doctor for professional diagnosis. |
| Device is not connected with the receiver | 1. Bluetooth does not open on receiver 2. Out of connection range 3. The device might not be worn correctly | 1. Turn on the Bluetooth of the receiver 2. Move the receiver closer 3. Adjust wearing position of the device 4. Please reset the Bluetooth connection on the receiver or restart the receiver. |

For more information, please visit: www.raing.com, or send an email to service@raing.com. We are looking forward to hearing from you.

8. MAINTENANCE & PRESERVATION

1. Replace the battery when low battery is indicated, otherwise the device will not function as intended.
2. Clean the surface of the device with 75% concentrated medicinal alcohol.
3. Store at temperatures of 0°C ~ 50°C (32°F ~122°F), with humidity of 10% ~ 85% and barometric pressure of 86kPa ~ 106kPa.
4. Treatment of the device and battery at the end of their life should comply with local laws and regulations.

Cautions: No extra calibration nor daily maintenance during the usage except the replacement of the battery.

9. CLEANING & DISINFECTION

The probe should be cleaned and disinfected.

Cleaning and Low-Level Disinfection

Clean the surface of the device with 75% concentrated medicinal alcohol before and after using.

Warnings

1. Use of cleaning agents and disinfectants other than alcohol may damage the device and shorten product lifetime or cause safety risks.
2. Do not soak the device in any liquid.
3. Do not sterilize or use an autoclave on the device.
4. If you notice any deterioration or damage, stop using the device immediately.

10. IMPORTANT PRECAUTIONS

In order to avoid unnecessary issues, please read the following information before using the wearable thermometer.

1. Warning: Any form of modification to this device is forbidden.
2. Do not use device together with MRI or CT equipment.
3. To avoid risk of explosion, do not use device with flammable anesthetic gas.
4. A qualified doctor should make the diagnosis of clinical manifestation and symptoms, with device as a subsidiary tool.
5. Please check device regularly to make sure that it is in firm contact with the skin. Otherwise data may be inaccurate.
6. Soaking device in liquid or disinfectant may lead to incorrect data or breakage.
7. Sudden movement of the users may lead to incorrect data.
8. Make sure to keep receiver charged when using it to monitor body temperature for a long period of time.
9. Do not apply pressure to device. If the cover is broken, stop using the device.
10. The temperature monitoring feature of device is primarily applicable to children. Muscle and fat affect wireless transmission, so range of transmission decreases if an adult or obese child uses device.
11. Pay attention to operating temperature and humidity. Using device in conditions that do not satisfy requirements may lead to measurement error.
12. Device is for indoor use only.
13. Please upgrade the application when necessary in the App Store/Google Play Store.
14. Please contact us if any app incompatible or conflicting issue was found although quite seldom.
15. The battery must be installed or replaced by the adults. Please put the battery and opening tool of the battery cover out of the reach of children.
16. This product has not been aseptically treated.
17. The battery shall be removed out of the compartment when not in use beyond one month.

11. TECHNICAL SPECIFICATIONS

| | | |
|---|--|--|
| Product name Wearable Thermometer | Valid transmission distance Up to 5 meters | Receiver iOS: Bluetooth v4.0 and iOS 11.0+ Android: Bluetooth v4.0 and Android 7.0+ For more information, please visit: www.raing.com |
| Model WT701 | Temperature unit °C or °F | Battery life 90 days at 8 hours per day Note: frequent synchronization of data may deplete power more quickly |
| Size 51.9mm × 31.6mm × 6.5mm | Measurement range 25 °C-45 °C or 77°F - 113°F | Operating conditions Temperature: 5°C - 40°C or 41°F – 104°F Humidity: 15% - 85% Barometric pressure: 86kPa - 106kPa |
| Weight 6g (without battery) | Accuracy ±0.05°C (35°C-38.5°C) ±0.1°C (<35°C and >38.5°C) or ±0.09°F (95°F – 101.3°F) ±0.18°F (<94.9°F and >101.3°F) | |
| Battery CR2025 | | |

12. FUNCTIONAL DESCRIPTION

1. Body temperature monitoring

The device connects to a receiver to monitor body temperature. It measures temperature and sends it to receiver via Bluetooth. Real-time temperature can then be seen on receiver.

2. Smart temperature alert

- The temperature reading becomes red with an audio notification on the receiver when the temperature reaches the threshold. The audio notification can be turned on and off, and the threshold can be set manually.

- Visual and audio notifications will be triggered when the temperature reaches the threshold even when the screen of the receiver is locked.

3. Bluetooth disconnection alert

A dialogue box appears and an audio notification sounds on receiver when Bluetooth connection is lost.

4. Temperature data storage











The device continues to measure and store body temperature independently if Bluetooth communication is lost during monitoring.

The device measures body temperature every 4 seconds and stores a maximum of 10 days of data. The stored data in the device is sent to the receiver as soon as the connection is resumed. Uploading 24 hours of data takes about 1 minute.

5. Low voltage indication

This function requires the connection between the device and the receiver. A pop-up window with alerts will appear on the receiver when the device's battery level is low.

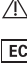
13. DEFINITIONS OF SYMBOLS

| | |
|--|--|
|  BF medical device |  No littering |
|  Manufacturing Date |  Recyclable |
|  Serial number |  Lot Number |
|  Manufacturer |  ROHS Certified |
|  Read user manual before use | |
|  Cautions! Please refer to the instruction for use. | |
|  European Authorized Representative | |

14. DISCLAIMER

This manual is written in accordance with available information and its contents are subject to change without notice. Raiing has made every effort to guarantee the contents of this manual are accurate and reliable. However, the company does not assume liability for any loss or damage caused by omissions, inaccuracies, or typographical errors in this manual.

Where a software upgrade leads to discrepancies in this manual, the software shall prevail. When product improves or technology changes, you may visit the company technical support website for the relevant information.

The Bluetooth® word mark, figure mark, combination mark, and Bluetooth Smart and Bluetooth Smart Ready marks are all trademarks that are owned by the Bluetooth SIG and any use of such marks by Raiing is under license. Other trademarks and trade names belong to their respective owners.

15. CAUTION

This device complies with part 15 of the FCC Rules. Operation is subject to the following two conditions:

1. This device may not cause harmful interference.
2. This device must accept any interference received, including interference that may cause undesired operation.

Changes or modifications not expressly approved by the party responsible for compliance could void the user's authority to operate the equipment.

FCC STATEMENT

Note: This equipment has been tested and found to comply with the limits for a Class B digital device, pursuant to part 15 of the FCC Rules. These limits are designed to provide reasonable protection against harmful interference in a residential installation. This equipment generates, uses, and can radiate radio frequency energy and, if not installed and used in accordance with the instructions, may cause harmful interference to radio communications. However, there is no guarantee that interference will not occur in a particular installation.

If this equipment does cause harmful interference to radio or television reception, which can be determined by turning the equipment off and on, the user is encouraged to try to correct the interference by one or more of the following measures:

- Reorient or relocate the receiving antenna.
- Increase the separation between the equipment and receiver.
- Connect the equipment into an outlet on a circuit different from that to which the receiver is connected.
- Consult the dealer or an experienced radio / TV technician for help.

16. DECLARATION

1. The EMC of the product meets the standard of IEC60601-1-2.
2. The material that comes in contact with skin is non-toxic, non-irritating, and up to standard of ISO10993-1, -5, -10.

17. COPYRIGHT STATEMENT

© Raiing Medical Company. All rights reserved. Raiing Medical Company retains the final right to interpret and revise this handbook to its statement.

Copyright of this manual belongs to Raiing Medical Company. Without prior written permission, no company or individual is allowed to reproduce, copy, or translate this manual or any information contained therein.

 Raiing Medical Company
FL4-E BLDG.8, Changliu Rd. 738 Machikou Town,
Changping Dist. Beijing, China

 MEQUIPEX E.U.
Feldstrasse 39/1/3, 4813 Altmuenster Austria

CE 0482

18. STANDARD WARRANTY INFORMATION

The product is warranted from manufacturing defects for one year from date of retail purchase. This does not cover the damages or wear resulting from accident, misuse, abuse, commercial use, or unauthorized adjustment and repair. Please direct all returns to the place of the original purchase. Please retain your original receipt as you may be asked to provide a copy for proof of purchase.

To find the Customer Service Menu, please go to our Company Website at: www.raing.com

19. APPENDIX

Reference from University of Michigan C.S. Mott Children's Hospital (<https://www.mottchildren.org/health-library/tw9223>)

Comparison of temperatures in Celsius by method. (This data is for reference only)

| Axillary/Forehead (°C/°F) | Oral (°C/°F) | Rectal/Ear (°C/°F) |
|---------------------------|---------------------------|---------------------------|
| 36.9–37.4°C/98.4–99.3°F | 37.5–37.7°C/99.5–99.9°F | 38–38.3°C/100.4–101°F |
| 37.5–38.4°C/99.4–101.1°F | 37.8–38.5°C/100–101.5°F | 38.4–39.1°C/101.1–102.4°F |
| 38.5–38.9°C/101.2–102°F | 38.6–39.1°C/101.6–102.4°F | 39.2–39.7°C/102.5–103.5°F |
| 39–39.5°C/102.1–103.1°F | 39.2–39.7°C/102.5–103.5°F | 39.8–40.3°C/103.6–104.6°F |
| 39.6–40°C/103.2–104°F | 39.8–40.3°C/103.6–104.6°F | 40.4–40.9°C/104.7–105.6°F |

20. PURCHASING RECORD FOR I THERMONITOR

Model Purchased: _____

Serial Number: _____

Date of Purchase: _____

Distributor Name: _____

Representative: _____

Phone Number: _____

Fax Number: _____

Email Address: _____